

Latest Developments in Air Leakage Testing

by Colin Genge
colin@retrotec.com

Copyright © 2008 Retrotec Energy Innovations Ltd.

Proper Reference of Flow Pressure

Depressurize

Copyright © 2008 Retrotec Energy Innovations Ltd.

Proper Reference of Flow Pressure

Pressurize

Copyright © 2008 Retrotec Energy Innovations Ltd.

Solutions

- Add a tube
- Self referencing fan
- Auto detection on gauge

Copyright © 2008 Retrotec Energy Innovations Ltd.

Error caused by flow that creates 1 Pa

n	C	cfm	at	error PR	error DP
0.6	1000	1000	1 Pa		
0.6	1000	3981	10 Pa	34%	20%
0.6	1000	10456	50 Pa	11%	9%

Copyright © 2008 Retrotec Energy Innovations Ltd.

Water in tube

- Shake it out

Copyright © 2008 Retrotec Energy Innovations Ltd.

Check Gauges Regularly

- T both channels together
- Check at several points

Copyright © 2008 Retrotec Energy Innovations Ltd.

Check Fans

- Field calibration for EqLA

Copyright © 2008 Retrotec Energy Innovations Ltd.

@ Pressure

- @ 50Pa means ?
- Predicted result at 50
- Uses:
 - increases accuracy
 - compensates for wind

Copyright © 2008 Retrotec Energy Innovations Ltd.



Adjustable @ Pressure

next shot bigger screen

Copyright © 2008 Retrotec Energy Innovations Ltd.

@ Pressure, at Set Pressure

PrA	25.00	Pa			
Flow	3800.10	cfm	@ 25.0Pa		
Volume =			1000m ³		
Speed =			50.0 %		
Open				Retrotec DU200	

Copyright © 2008 Retrotec Energy Innovations Ltd.



- @ Set Pressure
- @ Default Pressure
- @ OFF

Copyright © 2008 Retrotec Energy Innovations Ltd.

Any Device, Rt,Mn, Infiltec

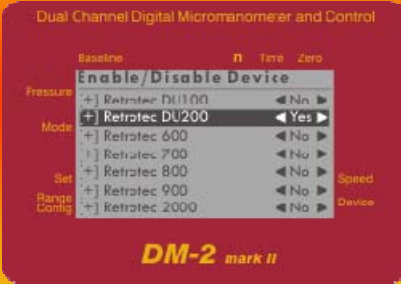

DM-2 mark II

Copyright © 2008 Retrotec Energy Innovations Ltd.

Any Result



DM-2 mark II

Copyright © 2008 Retrotec Energy Innovations Ltd.

Any Result

- Pressure + Pressure, any units
- Pressure + Flow, any units
- CFM @50 or @ any pressure
- Air changes per hour @50, key volume
- Air- flow/ area, key area
- EqLA/ Area, key area
- EfLA/ Area, key area

Copyright © 2008 Retrotec Energy Innovations Ltd.

LEED 0.25 in² EfLA/100ft² @ 4Pa



DM-2 mark II

Copyright © 2008 Retrotec Energy Innovations Ltd.

Set up

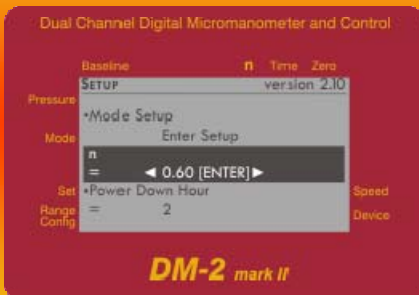

DM-2 mark II

Copyright © 2008 Retrotec Energy Innovations Ltd.



Choose from:

- 2 gauges
- 4 controls
- 3 panels
- 4 fans

Copyright © 2008 Retrotec Energy Innovations Ltd.

Fan Control

2 class of motor in 2 class of housing

Model 2100
2100 Fan assembly

Model 2200
2200 Fan assembly

Model 2300
2300 Fan assembly

Model 2400
2400 Fan assembly

Model 2500
2500 Fan assembly

Model 2600
2600 Fan assembly

Model 2700
2700 Fan assembly

Model 2800
2800 Fan assembly

Model 2900
2900 Fan assembly

Model 3000
3000 Fan assembly

Copyright © 2008 Retrotec Energy Innovations Ltd. **retrotec**

Door Panels

Class Door Panel

Modular Door Panel

Two Fan Modular Panel

Three Fan Folding Panel

Copyright © 2008 Retrotec Energy Innovations Ltd. **retrotec**

Fan Performance

All Retrotec fans include flow restrictor plates that enable testing in wide range of enclosures from super tight to super tight. Retrotec Model 2100 and 2200 and 2300 fans include 11 flow restrictor plates for super tight testing and achieve accurate results regardless of the enclosure leakage properties. 100 CFM models (2400) have multiple flow restrictor plates to test in tight enclosures or ducts with leakage from 1 to 100 CFM (2500). Range configurations settings are integrated with Retrotec's digital pressure flow restrictor results.

Retrotec Fan Range Performance
Flow restrictor in CFM @ 10 Pa

Each range configuration will test between the minimum maximum flow restrictor with a huge number of range restrictor fans seen in a wide range of buildings or enclosures.

Copyright © 2008 Retrotec Energy Innovations Ltd. **retrotec**

Component Specifications

Model	Flow Restrictor	Flow Restrictor	Flow Restrictor	Flow Restrictor
Model 2100	11	11	11	11
Model 2200	11	11	11	11
Model 2300	11	11	11	11
Model 2400	11	11	11	11
Model 2500	11	11	11	11
Model 2600	11	11	11	11
Model 2700	11	11	11	11
Model 2800	11	11	11	11
Model 2900	11	11	11	11
Model 3000	11	11	11	11

Copyright © 2008 Retrotec Energy Innovations Ltd. **retrotec**

Energy System Selector

6 Models popular for energy testing

Copyright © 2008 Retrotec Energy Innovations Ltd. **retrotec**

Duct Leakage to Outdoors

Copyright © 2008 Retrotec Energy Innovations Ltd. **retrotec**

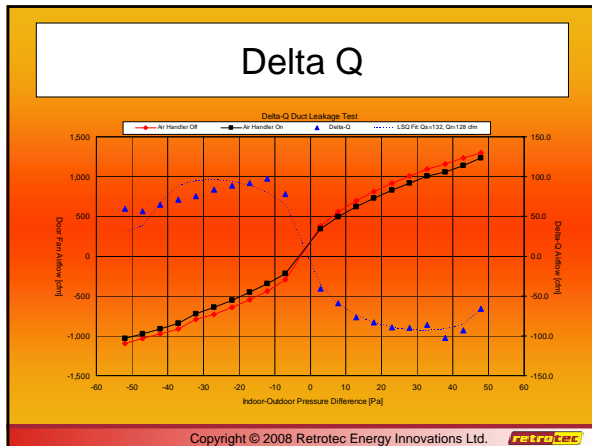

Door-Fan 3 Auto-Test

- Certificates
- Any Std
- Any # pts
- min/max
- both ways

Copyright © 2008 Retrotec Energy Innovations Ltd. **retrotec**

Door-Fan 3 Any equipment

Copyright © 2008 Retrotec Energy Innovations Ltd. **retrotec**

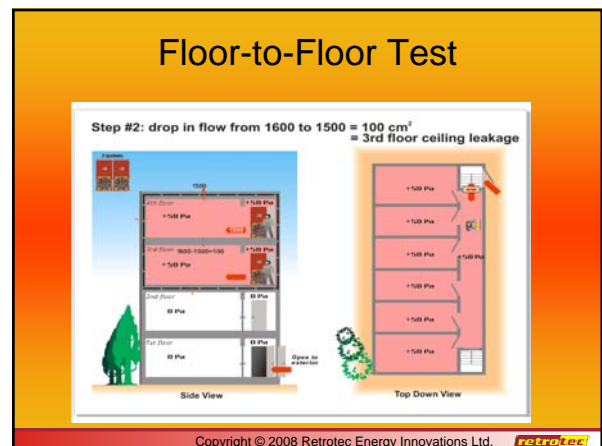
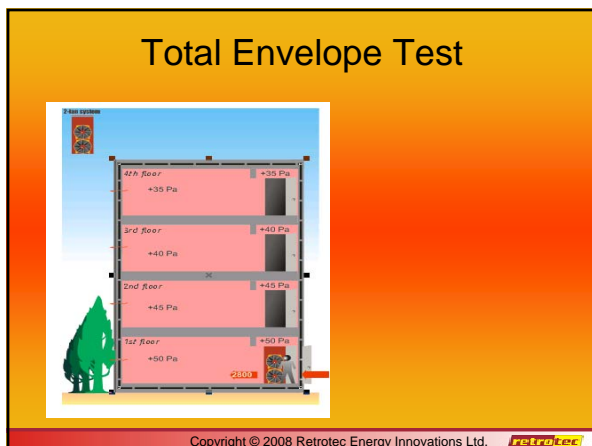
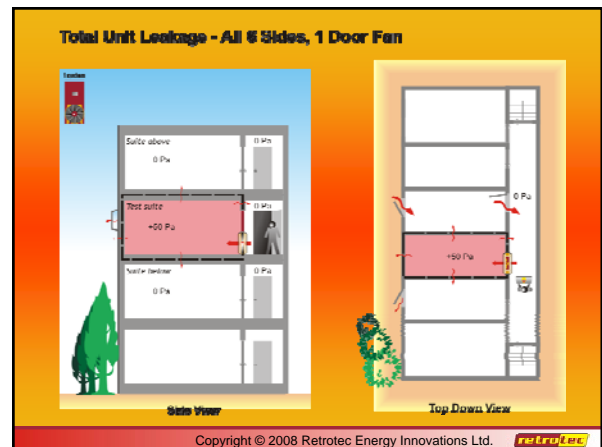

Various Standards Converted to:
cm² EqLA per m² envelope @ 50 Pa

n=0.6 for an <u>apartment</u> , 120 x 110 x 8 ft, 4 stories	house	Apt.
Canadian R-2000 1 in ² EqLA @ 10 Pa /100 ft ² envelope	0.9	0.8
Canadian R-2000 house 1.5 air changes/ hour	0.8	2.4
US Army standard is 0.25 cfm/ ft ² at 75Pa	1.8	1.8
UK 3 m ³ /h/m ² at 50 Pa Best practice, House	1.5	1.5
LEED, 1.25 in ² EflA @ 4 Pa / 100 ft ² envelope	2.1	1.9
UK 5 m ³ /h/m ² at 50 Pa Best practice, Commercial	2.5	2.5
Danish House Standard 1.5 l/s/m ² floor @ 50 Pa	2.7	2.7
IECC standard is 0.4 cfm / ft ² at 75Pa	2.8	2.9

Copyright © 2008 Retrotec Energy Innovations Ltd. 

Total Unit Leakage - All 6 Sides, 1 Door Fan



Copyright © 2008 Retrotec Energy Innovations Ltd. 

Numerous Apartment Buildings Tested



Copyright © 2008 Retrotec Energy Innovations Ltd. 



Copyright © 2008 Retrotec Energy Innovations Ltd. 



Copyright © 2008 Retrotec Energy Innovations Ltd. 

Leakage on all 6 sides
cm²/m² @ 50 Pa

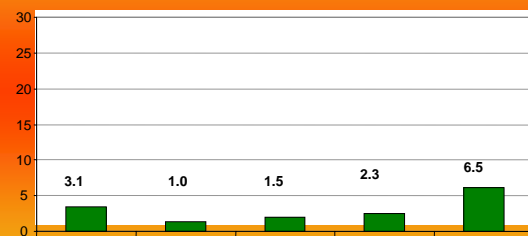

Copyright © 2008 Retrotec Energy Innovations Ltd. 

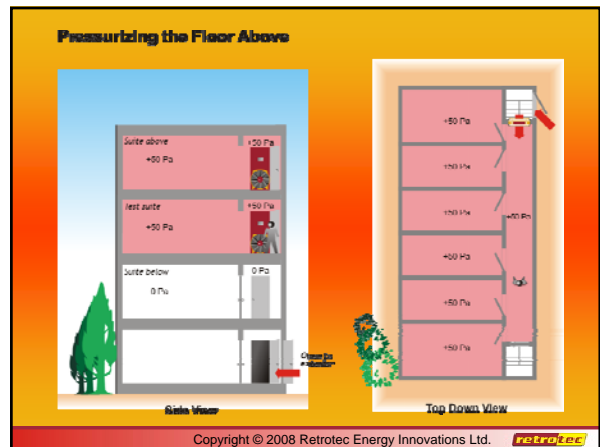
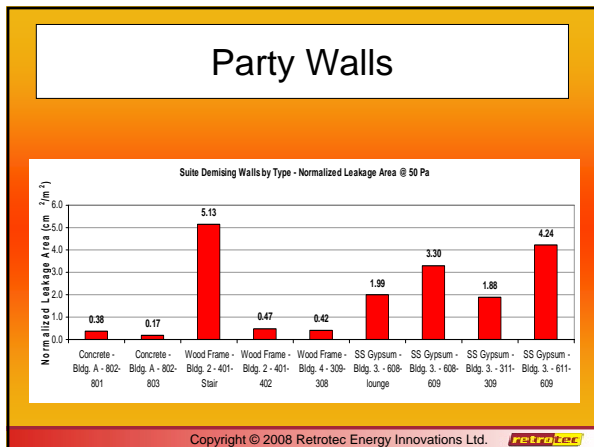
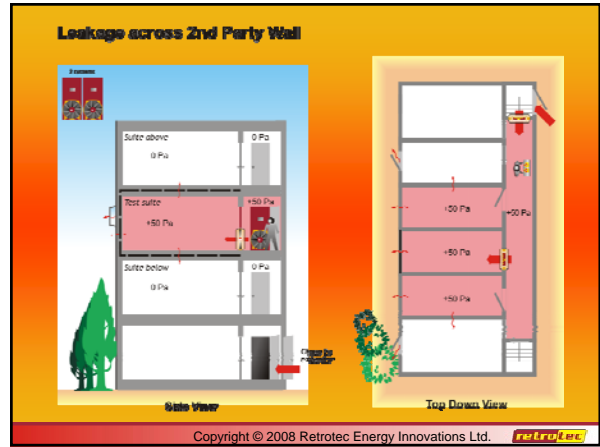
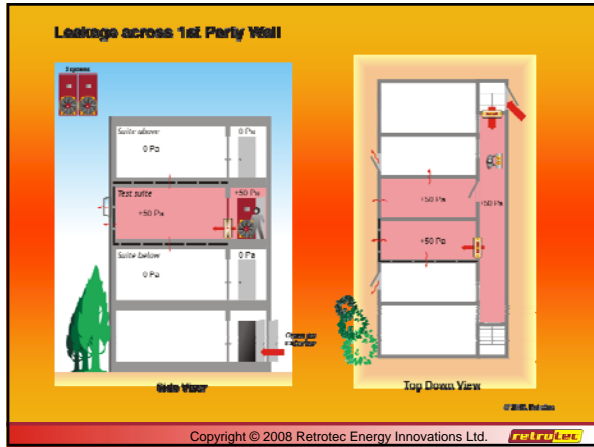
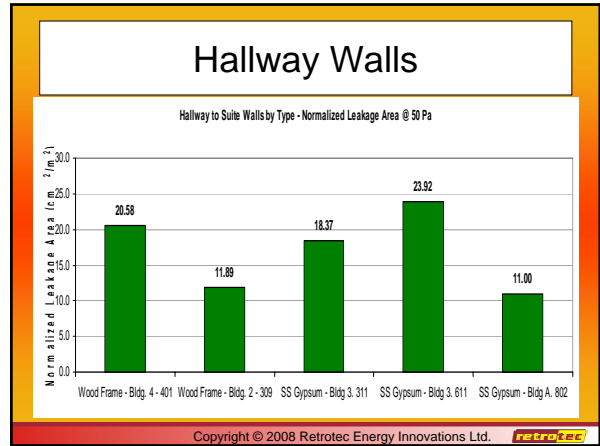
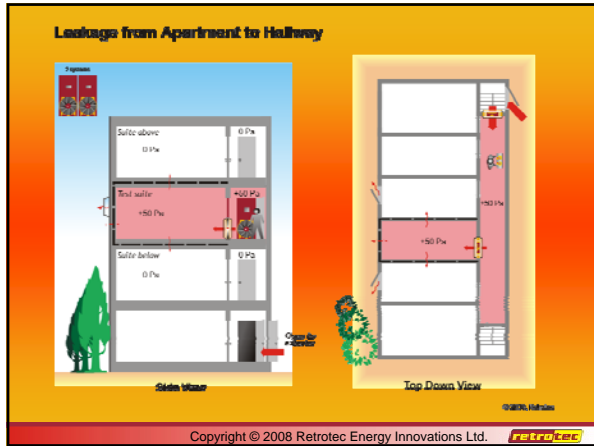

Floor Leakage

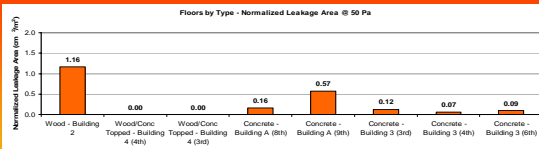

Copyright © 2008 Retrotec Energy Innovations Ltd.



Exterior Walls

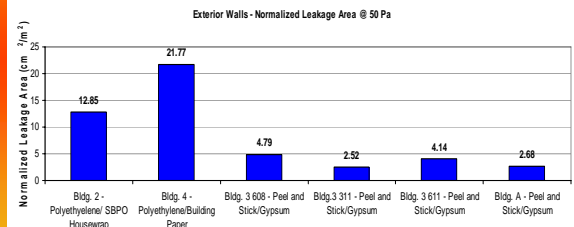

Copyright © 2008 Retrotec Energy Innovations Ltd.



Conclusions

- Leakage of any surface can be tested

Copyright © 2008 Retrotec Energy Innovations Ltd.



retrotec

airflow systems since 1978

www.retrotec.com

Copyright © 2008 Retrotec Energy Innovations Ltd.

