

Diagnostic Tools and Software in Glazing

Tools

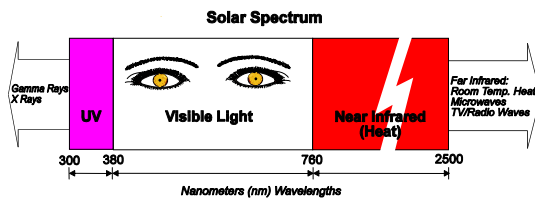

The Solar Spectrum



Solar Energy

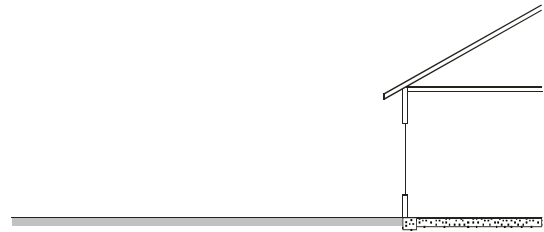

Companies

- EDM
- MLM Enterprises
- Southwall Technologies Inc.

Southwall Technologies Inc.

- The Originators
- Beam Splitter
 - A reference tool

EDTM

- “Energy Pro” #EP3500
- Estimates
 - SHGC
 - UV
 - VLT

EDTM

- Spectrum Detective: Energy
 - Transmission meter # SD2400
 - Compact...Battery Operated
 - Estimates
 - SHGC
 - UV
 - VLT

EDTM

- Self-Clean Coating Detector
- Residential Solar Gain Low-E Detector
- Manual Glass and Air Space Laser Gauge
- Strengthened Glass Detector
- Dual Transmission Meter
- UV Transmission Meter
- ETEKT+ Low-E Coating Detector

Residential Window Selection

- **Alliance to Save Energy**
Efficient Windows Collaborative (EWC)
1850 M Street NW, Suite 600
Washington, DC 20036
(202) 857-0666 phone (202) 331-9588 fax
info@ase.org www.ase.org
Window Program of U.S. Department of Energy, in collaboration with industry members of EWC www.efficientwindows.org This web site provides unbiased information on the Benefits of energy-efficient windows, descriptions of how they work, and recommendations for proper use.

San Diego,
California

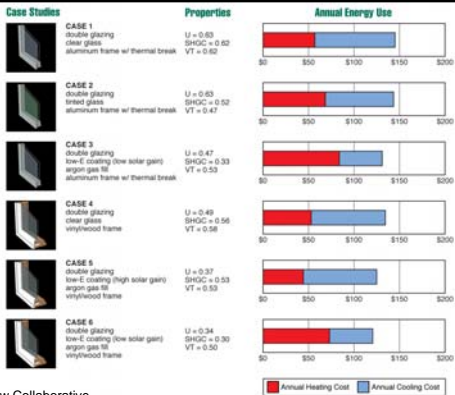

© Efficient Window Collaborative

American Society of Civil Engineers

- **ASCE 7-95**
Title: "Minimum Design Loads for Building and Other Structures"
To Purchase: ASCE
American Society of Civil Engineers
Publications Marketing Department
1801 Alexander Bell Drive
Reston, VA 20191-4400
(800) 548-2723 phone
(703) 295-6333 fax
Publications: www.pubs.asce.org

Permanent Label



Flash Windows & Doors Properly

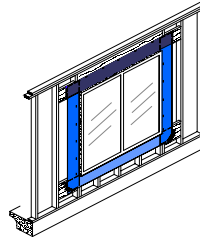

- Type Flashing
 - Nine (9") inches for side.
 - Twelve (12 ") inches for head.
- Dual Caulk or Self-Adhesive Flashing

ASTM Installation Standards

- **ASTM E06.57.11**

Title:

"Standard Practice for Installation of Exterior Windows and Doors and Skylights"

To Purchase:

National Building Science Corp.
32244 Corte Chatada
Temacula, CA 92592-6230
(951) 699-0116 phone
(951) 699-0876 fax
(951) 265-1501 cell

NFRC

- National Fenestration Rating Council, Inc.
6305 Ivy Lane, Suite #140
Greenbelt, MD 20770
(301) 589-1776 phone
(301) 589-3884 fax

info@nfr.org
www.nfr.org

OTHER INDUSTRY LINKS WEBSITE GUIDE

- American Architectural Manufacturers Association www.aamanet.org
- American Institute of Architects (AIA) www.aia.org
- American National Standards Institute (ANSI) www.ansi.org
- American Society of Civil Engineers (ASCE) www.asce.org
- American Society of Heating, Refrigerating, and Air-Conditioning Engineers (ASHRAE) www.ashrae.org
- American Society for Testing Materials (ASTM) www.astm.org
- Building Envelope and Thermal Envelope Council www.nibs.org

- Canadian Window and Door Association www.cwdma.ca
- Construction Specification Institute (CSI) www.csinet.org
- Insulating Glass Manufacturers Alliance www.igmaonline.org
- International Code Council (ICC) www.intlcode.org
- International Organization for Standardization www.iso.ch
- Lawrence Berkeley National Laboratories windows.lbl.gov
- National Fenestration Rating Council (NFRC) www.nfr.org
- National Glass Association www.glass.org
- National Resource for Global Standards www.nssn.org
- Window and Door Manufacturers Association www.wdma.com

Information & Technical Assistance



Dr. James O'Bannon

Richard Heath & Associates, Inc.
(530) 898-1323 Phone

Email: jim@rhainc.com

